

Cardboard Edge Protector Cutter

FEATURES

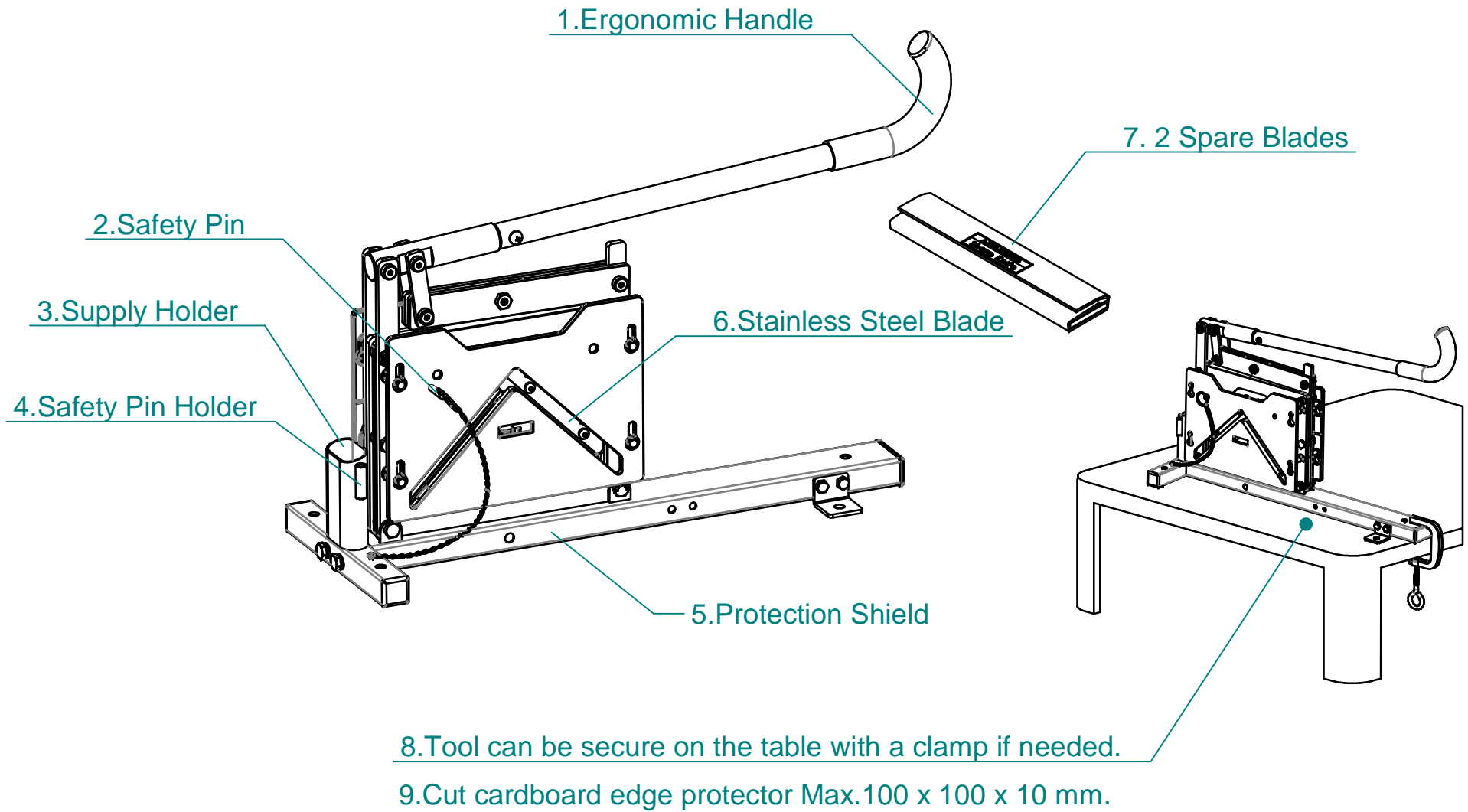

Cardboard Edge Protector Cutter

Part No.	Part Name	QTY
02	Overall Base Group	1
34	Washer	4
58	Cutter Block	2
60	Blade x2	1
61	Screw	4
69	Screw	1
71	Nylon Nut	2
73	Handle Assembly	1
81	Screw	1
87	Protection Shield	2

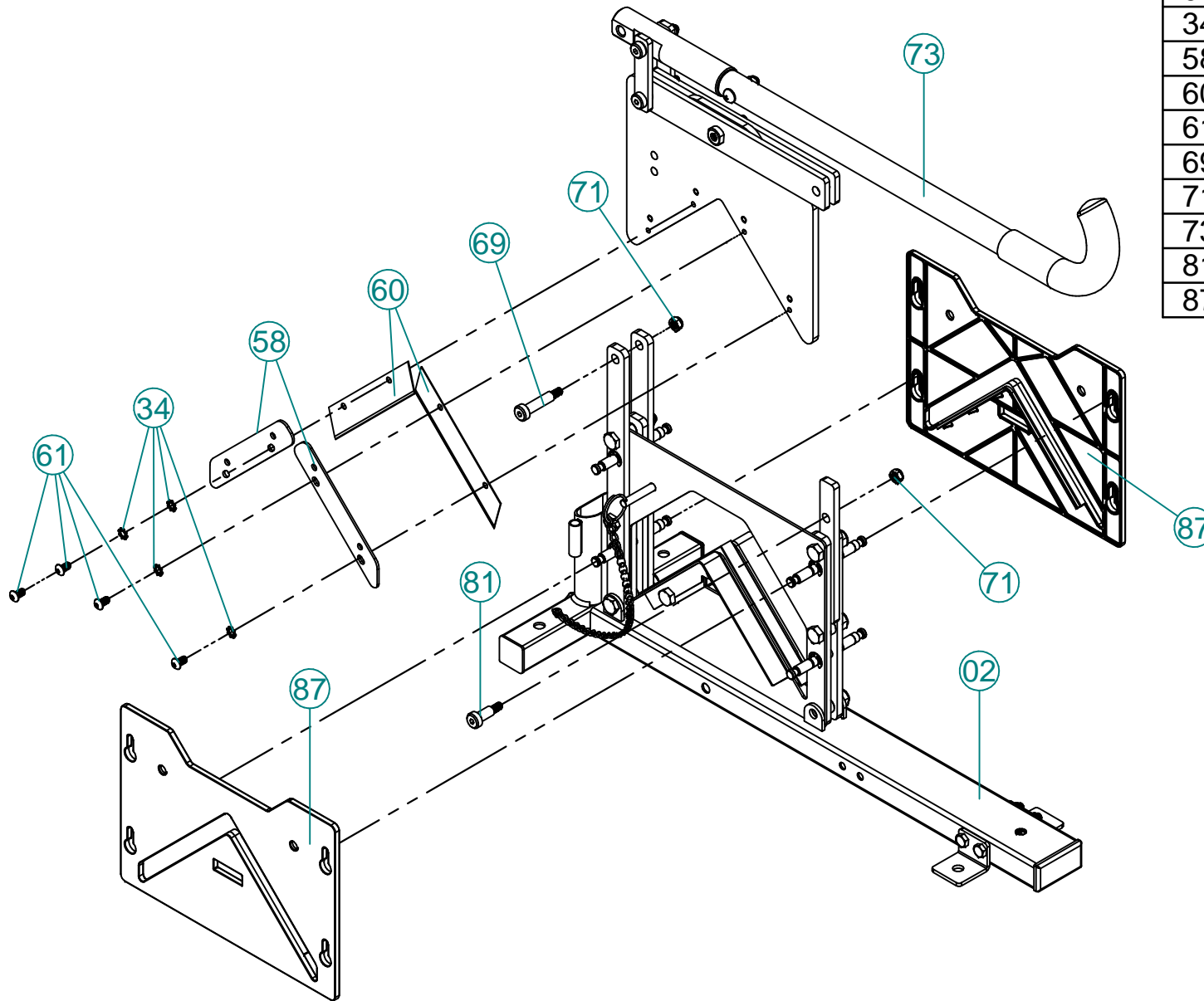

Cardboard Edge Protector Cutter

MAINTENANCE

1. Replace the blades when dull to ensure quality of cutting.
2. Clean the tool with brush or periodically blowing dust or dirt off with clean, dry compressed air.
3. Apply light machine oil to all moving parts regularly.

BLADE SPECIFICATIONS

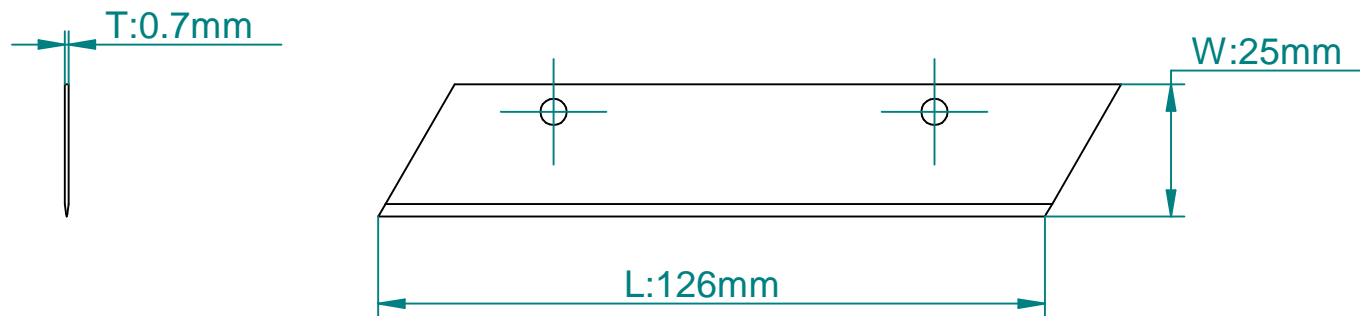

Material:Stainless Steel
Part No.AC100-60
(Include 2 blades in paper cardboard box)

Cardboard Edge Protector Cutter

OPERATING INSTRUCTIONS

1

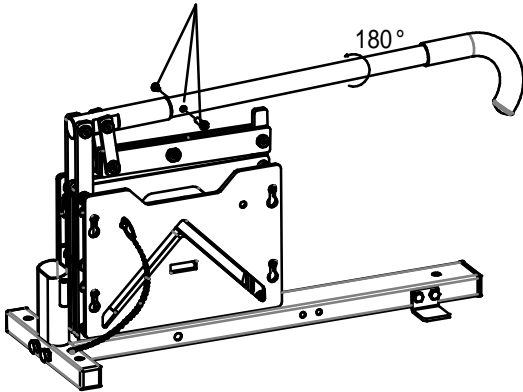

Loosen the screws with a screw driver and a hex wrench. Turn the handle up 180° and tighten the screws back.

2

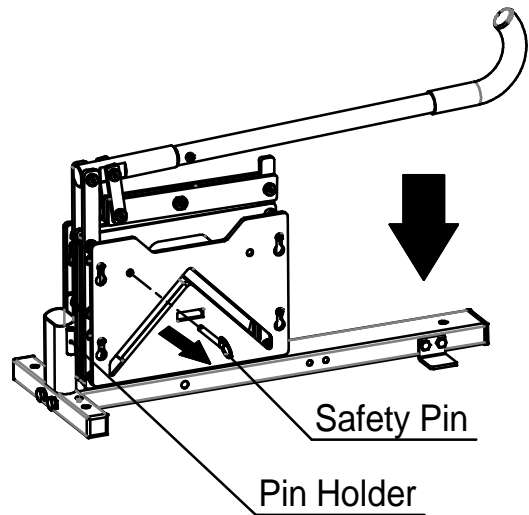

Press the handle down and while at this position, pull the safety pin out. The tool is now ready to work. Keep the safety pin in the pin holder.

3

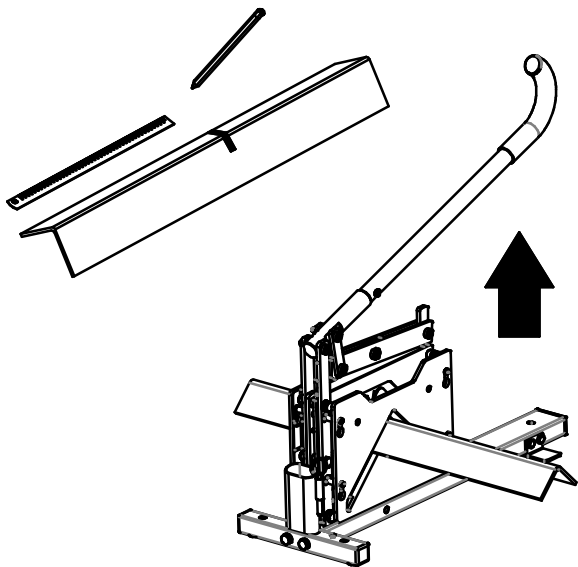

Use a ruler to measure the length you want to cut off. Make a mark there. Lift the handle so the edge protector can be inserted to the cutter slot. Cut the edge protector at the mark you make.

4

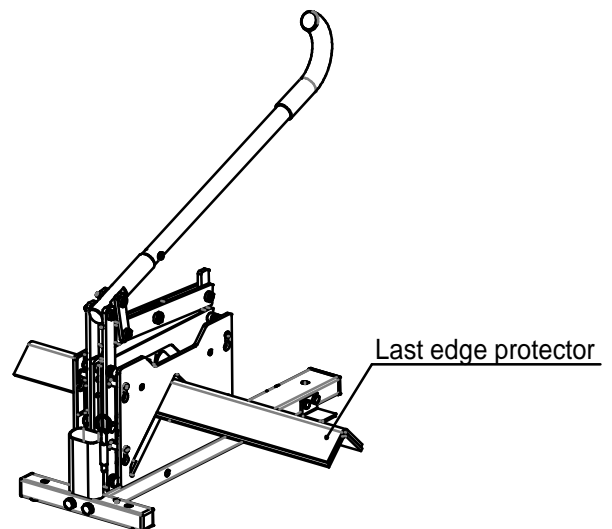

Use and hold the last edge protector as a ruler to measure the length you want to cut off if you want to cut the same size off as last one.

Cardboard Edge Protector Cutter

OPERATING INSTRUCTIONS

5

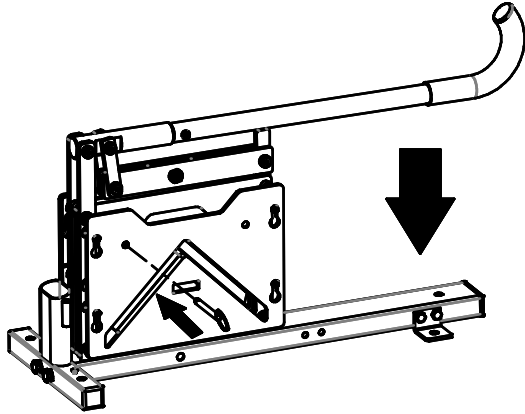

Press the handle down and while at this position, insert the safety pin.

6

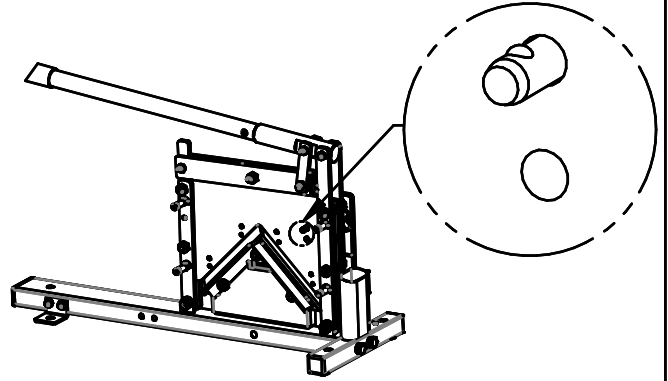

Check the other side of tool. **The pin should protrude out of the top hole like shown.**

7

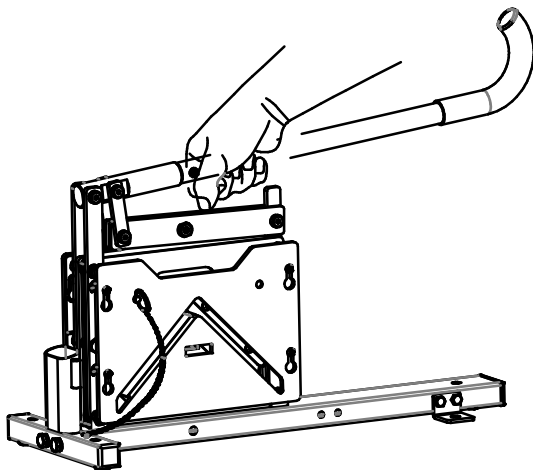

The safety pin now locks the movement of handle. **For safety reason, always lock the movement of handle when not in use.** In this condition, the tool is good for hand carry too.

Cardboard Edge Protector Cutter

BLADE REPLACEMENT

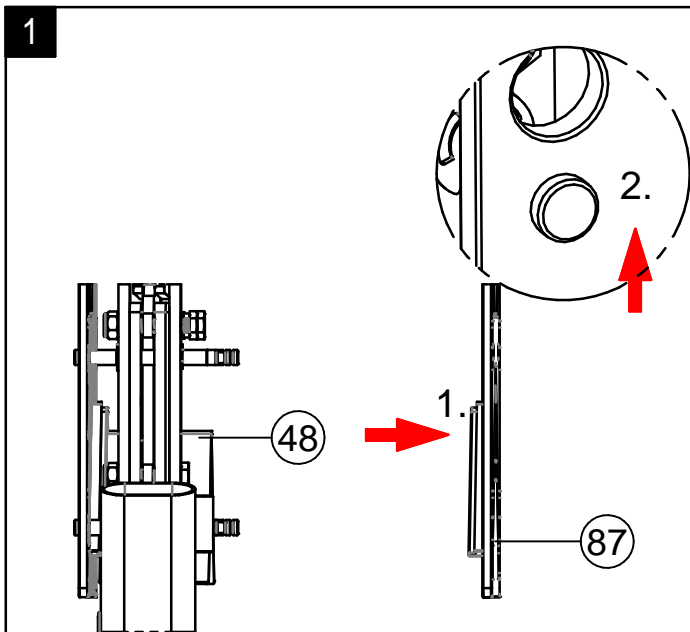

Step 1: Release the triangular rib on the (87) Protection Shield out of the (48) Block Plate.
Step 2: Pull up the (87) Protection Shield to remove.

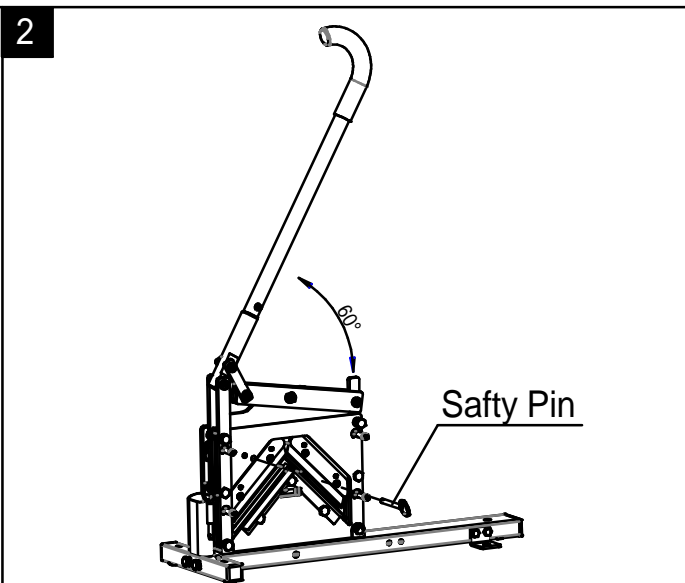

Lift the handle approximately 60° up so the safety pin can be inserted to a hole.

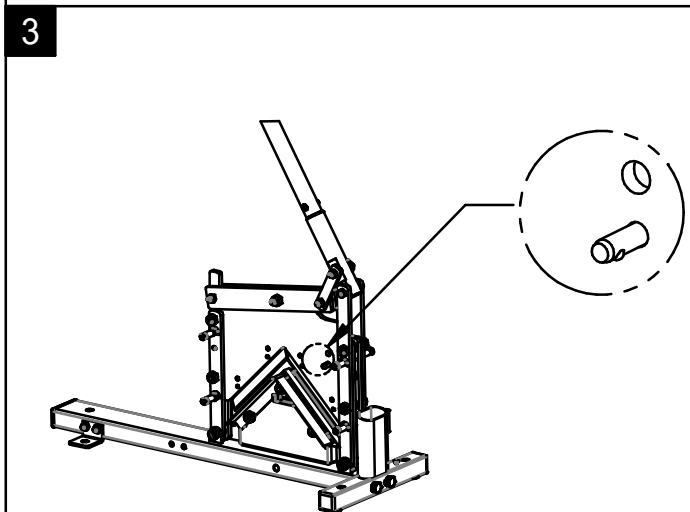

Look at the other side of the tool. **The pin should protrude out of the bottom hole.** The safety pin now blocks the movement of handle. The blades are also away from the cutting board and ready for the replacement.



Not following this instruction may cause injury to fingers.

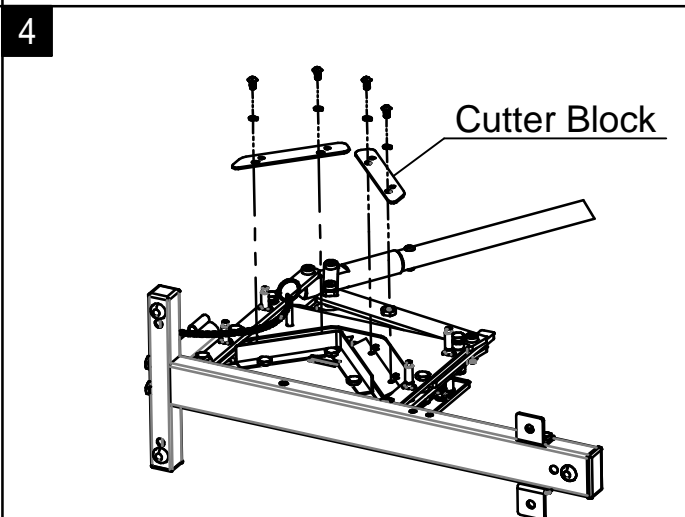

Put the tool down in a horizontal position. Use a hex wrench to free screws and washers. Take away 2 cutter blocks.

Cardboard Edge Protector Cutter

BLADE REPLACEMENT

5

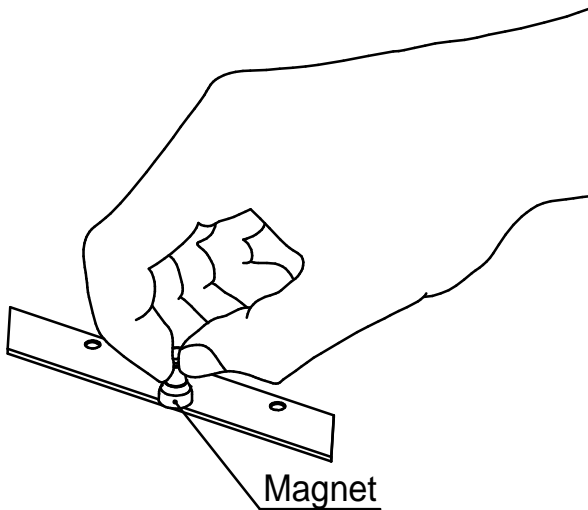

For safety reason, use magnet to hold the new blade.

6

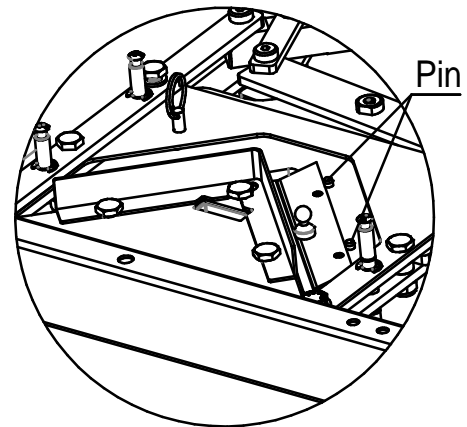

Hold the blade with magnet. Put the blade against the pins.

7

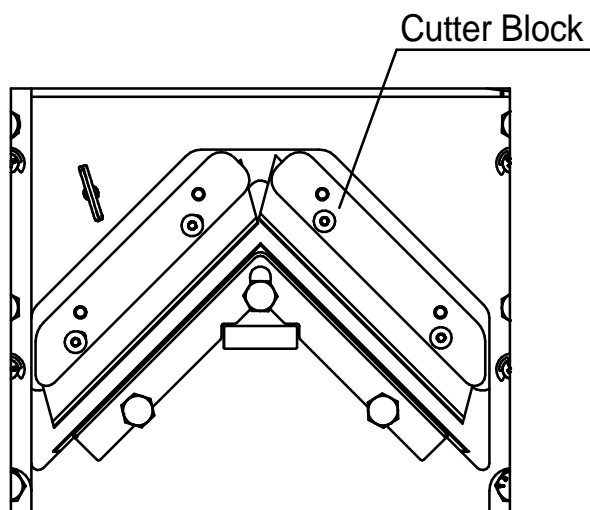

Put the cutter block back. Fasten 2 screws and washers. Repeat the same step to the other side of blade.

8

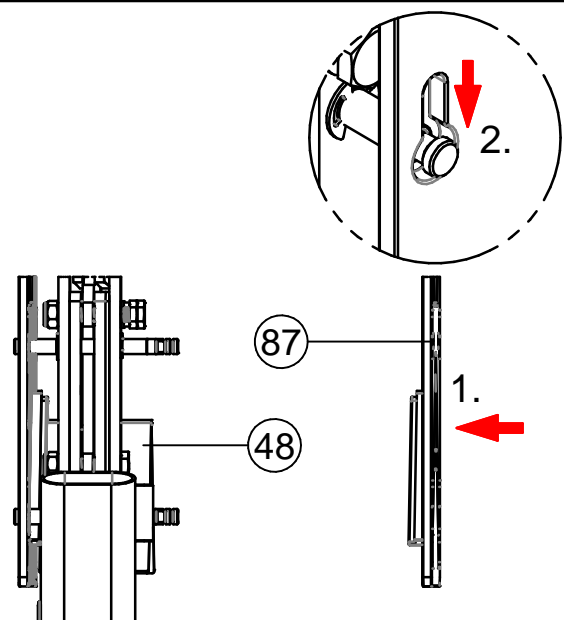

Step 1: Install (87) Protection Shield, make sure the triangular rib on the (87) Protection Shield is beneath (48) Block Plate.

Step 2: Push down the (87) Protection Shield to fix.